



01

## Event and Congress Center Forum Schönblick

The newly constructed Forum Schönblick is embedded in the surrounding park landscape at the edge of the Rems Valley. Seminar rooms and a chapel that serves as a place for quiet contemplation are grouped around the hall where church services and cultural events take place. The hall is positioned between the other buildings and is closed towards the north. Facing the south, the building opens out towards the landscape. Natural light, the acoustics of the room and the artistic design from sculptor Karl Imfeld permeate the atmosphere. The shape of the seminar room is adjusted to fit the overall plan of the building. As a light, transparent skeleton structure, this part of the building is set in front of the other sections.

01 Panoramic view | 02 Hall | 03 Site plan | 04 Interior | 05 Biblical wall

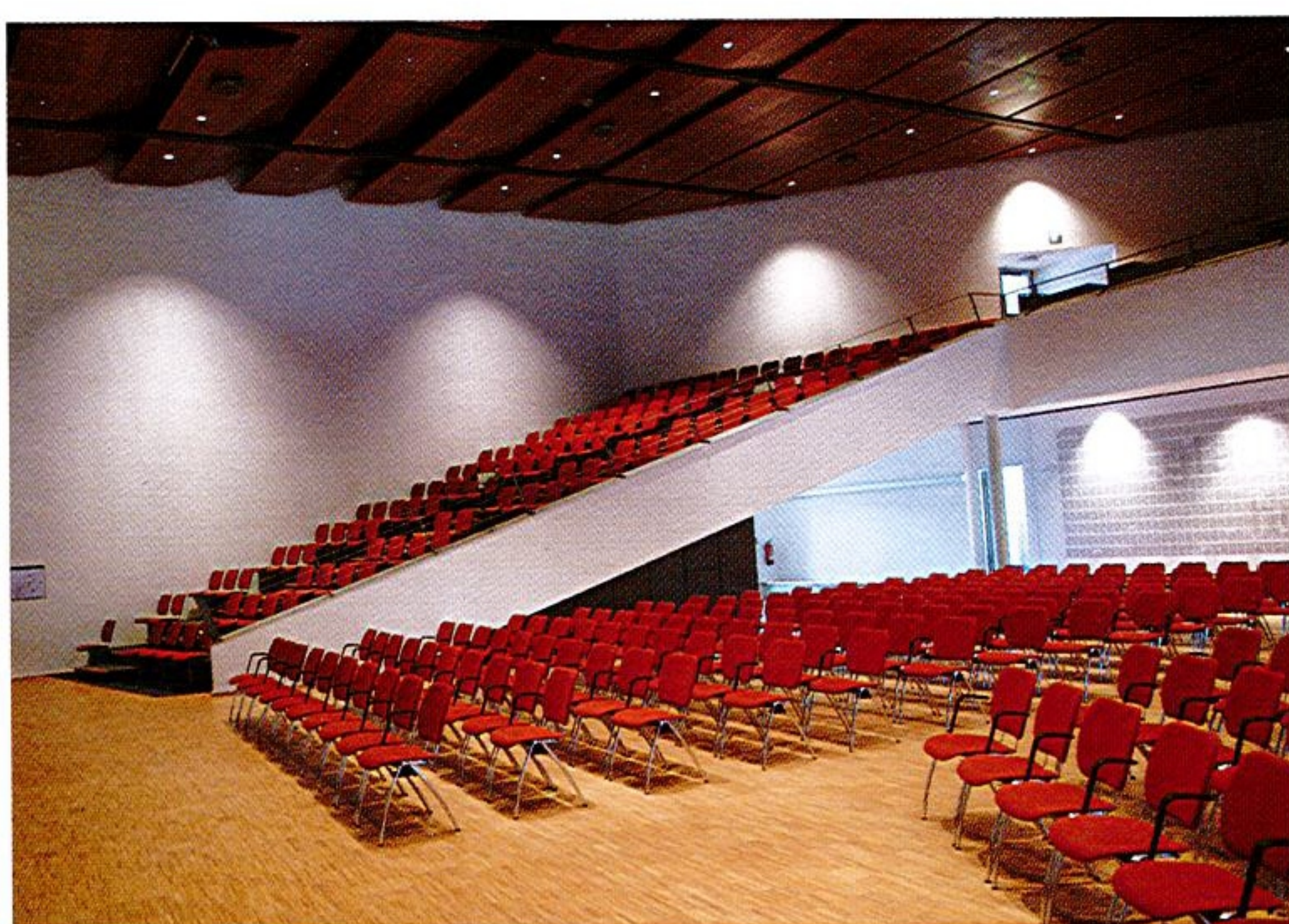

02

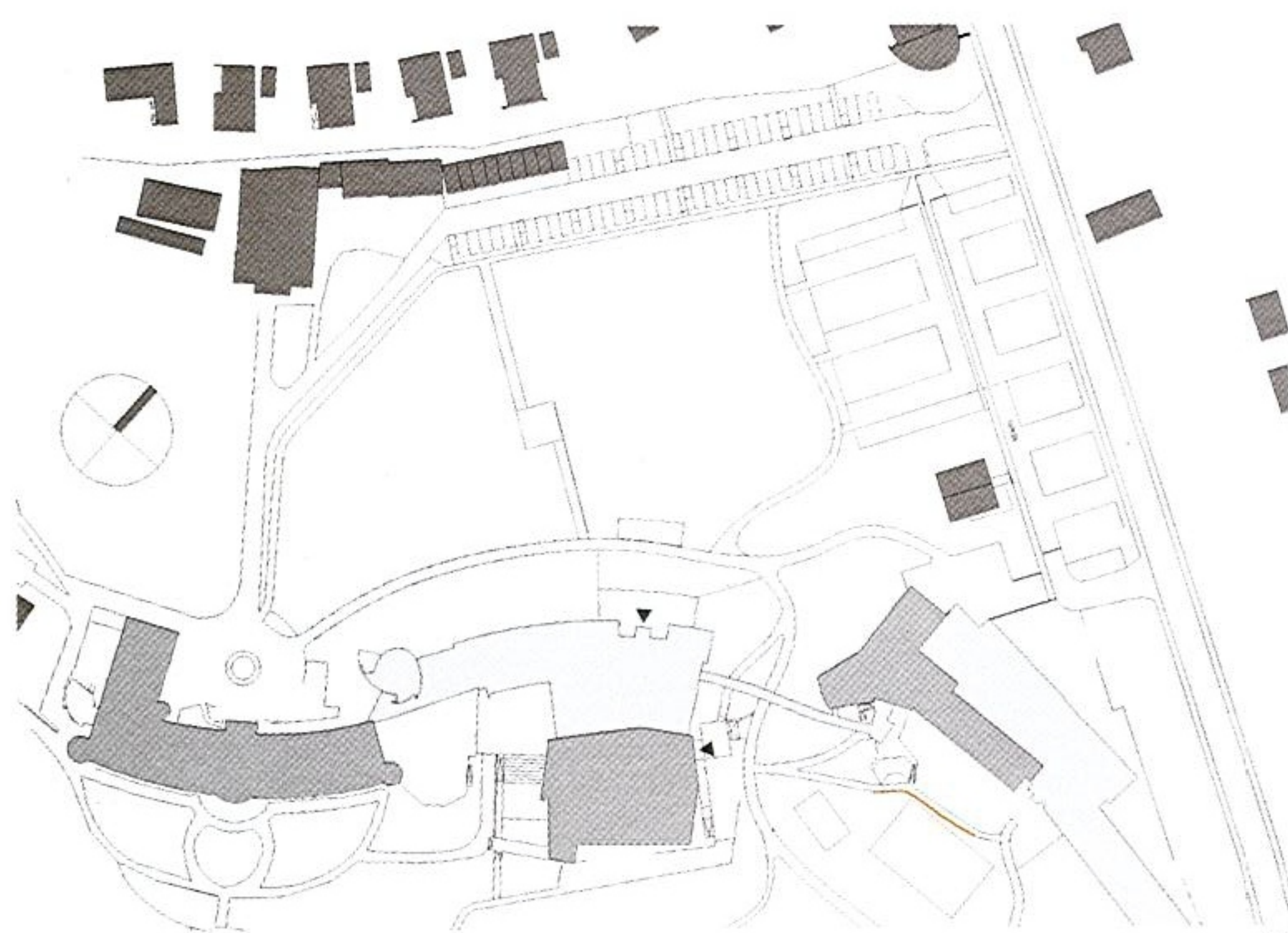

03

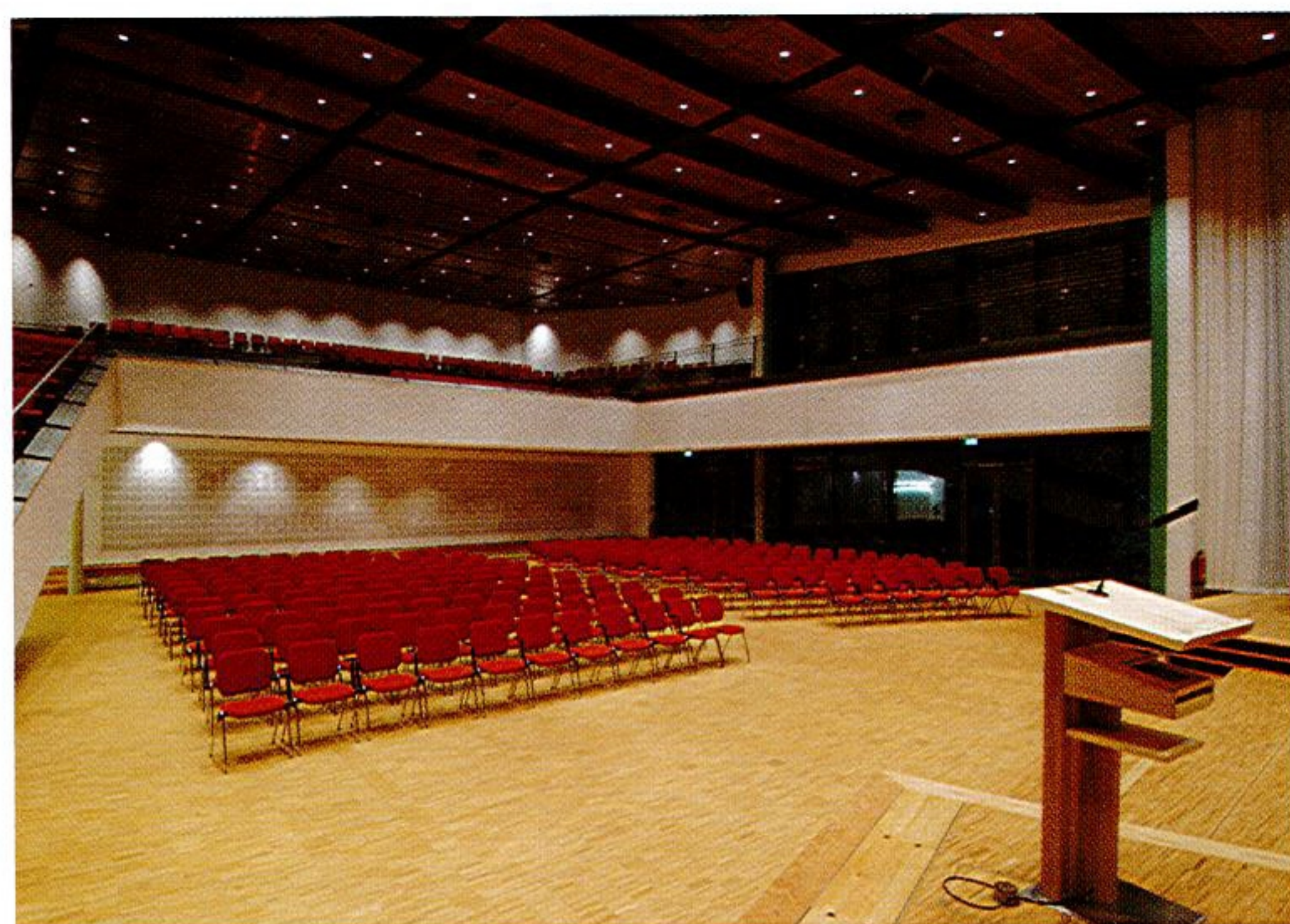

04

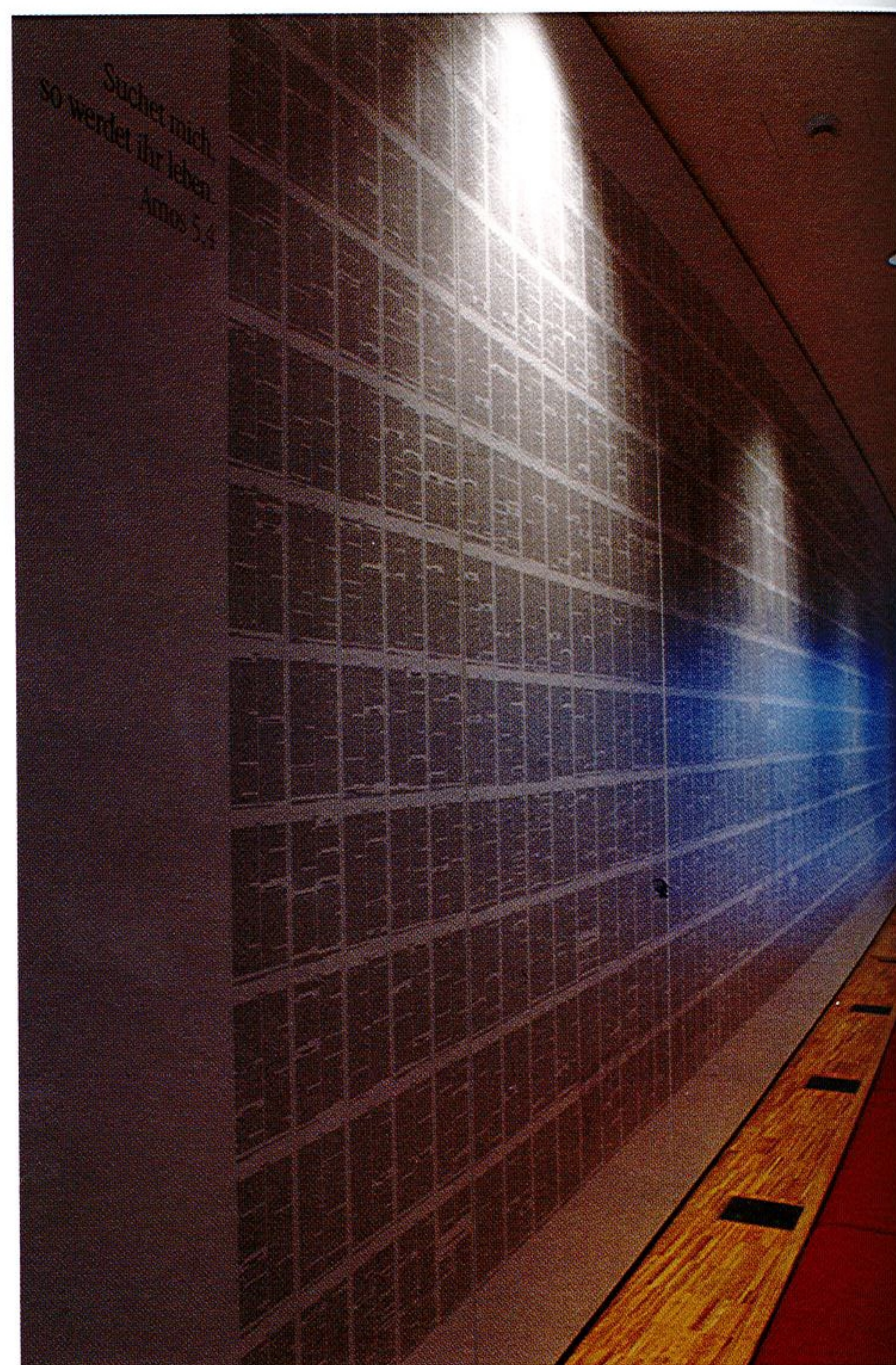

05