

RING ATTACHED BY ADHESIVE APPLIED TO THIS SURFACE.

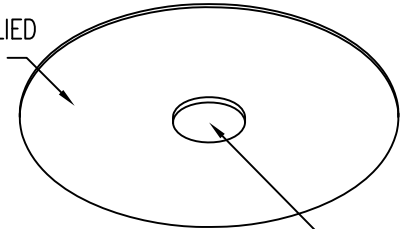

INTERNAL PRESSURE SENSITIVE ADHESIVE FIXTURE HOLDS RING WHILE ADHESIVE CURES.

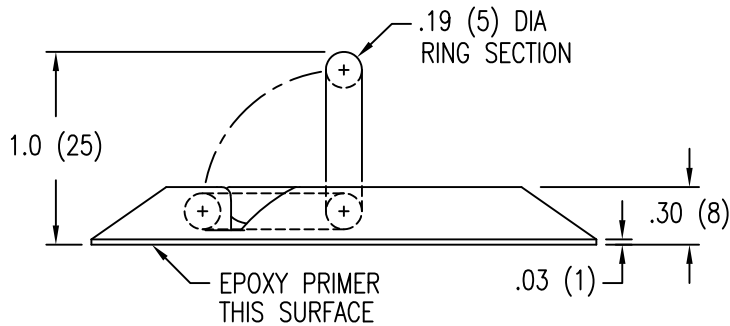

NOTE: DIMENSIONS IN INCHES (mm)

MATERIAL AND FINISH DATA

CODE	BASE AND WASHER MATERIAL	RING AND HUB MATERIAL	FINISH
CRM	316 CRES	316 CRES	PASSIVATE
CRA	316 CRES	A-286 CRES	PASSIVATE

ABS DESIGN LOADS

CODE	TENSILE STRENGTH
CRM	400 lbs
CRA	800 lbs

EXAMPLE PART NUMBER

CM988 CRM P

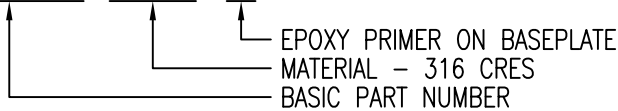

UNLESS OTHERWISE SPECIFIED, ALL DIMENSIONS ARE IN INCHES AND TOLERANCES ARE AS SHOWN BELOW. DIMENSIONAL TOLERANCES AND SYMBOLS PER ANSI Y14.5M-1982.

PROPRIETARY PARTS SHOWN IN THIS DRAWING ARE THE SUBJECT OF ISSUED UNITED STATES AND FOREIGN PATENTS AND PATENTS PENDING. UNAUTHORIZED REPRODUCTION AND/OR DISTRIBUTION OF THIS DRAWING IS SPECIFICALLY PROHIBITED.

**CLICK BOND**

CARSON CITY  
NEVADA 89706

APPROVALS		DATE	TITLE		
ANGLES	±1°	DRAWN <i>DAC</i>	RING, TIE DOWN, FLUSH		
.XX	±.03	CHECKED <i>DAC/mtm</i>	SIZE	CAGE CODE	DWG. NO.
.XXX	±.010	RELEASED <i>DAL</i>	A	66530	CM988
.XXXX	±.001	REVISED <i>BPerez</i>	SCALE	1/1	4NOV15
					SHEET 1 OF 1