

PAOLO ASTORI

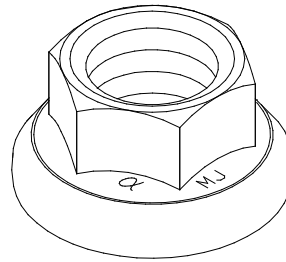

PAOLO ASTORI s.r.l.
via Mirabella 9-MAGGIATE SUP.
I 28013-GATTICO (NO)



JDRS10
JDRS11

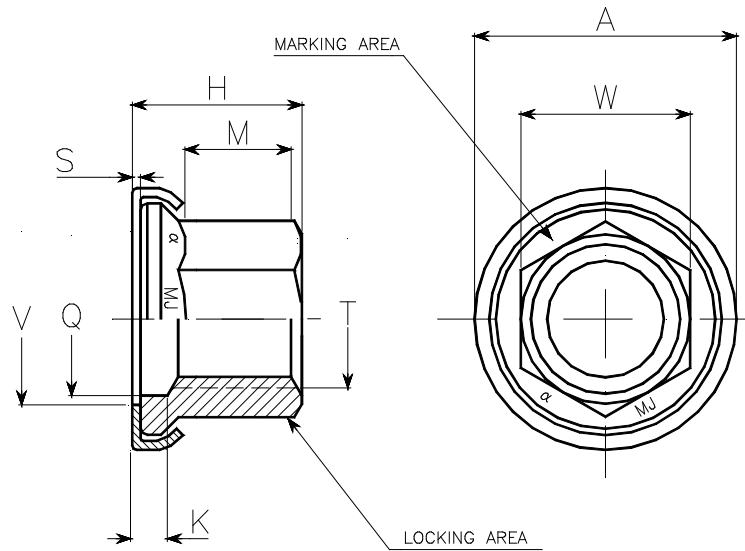

dimensioni in mm. dimensions in mm.

codice dimensioni dimensions code	filettatura T thread T	A max.	H max.	K min.	M min.	Q min.	S min.	V max.	W h13	mass kg x 1000
03	MJ3x0,5 4H-6H	6,7	4,6	1,6	1,2	3,4	0,4	3,8	4	0,4
04	MJ4x0,7 4H-6H	8,4	6,2	2,2	1,5	4,4	0,4	4,8	5	0,86
05	MJ5x0,8 4H-6H	9,6	7,4	2,4	2,0	5,5	0,6	5,8	6	1,16
06	MJ6x1 4H-5H	11,1	8,1	2,7	2,3	6,5	0,6	6,8	7	1,61
08	MJ8x1 4H-5H	14,6	9,9	2,7	3,2	8,5	0,6	9,0	10	3,83
10	MJ10x1,25 4H-5H	17,2	12,0	3,0	3,8	10,5	0,6	11,0	12	7,56
12	MJ12x1,25 4H-5H	21,0	13,8	3,0	4,5	12,5	0,6	13,0	14	11,06

material code	material		finish		hardness HRC	strenght class	temperature class
	washer	nut	washer	nut			
JDRS10L	W1.7214.4 25CD4	W1.7220.4 35CrMo4	cadmium plating	cadmium plated +MoS ₂	44 max.	1100 MPa	235°C
JDRS11L	W1.4544.9	W1.4944.4 alloy A286	passivation	passivation+ MoS ₂ + green dot	28-36		315°C
JDRS11A	AISI321			argentatura			

THREAD: according to ISO 5855.
MARKING: Manufacturer identification symbol α and letters MJ
PROCUREMENT SPEC. : LN65016
ASTORI CALL-OUT: material code - dimensions code.

Reference
DIN65507
DIN65508

**DADO AUTOFRENANTE,ESAGONO RIDOTTO,
RONDELLA INCORPORATA,CRES
NUT, SELF-LOCKING,REDUCED HEX,
CAPTIVE WASHER, CRES**

JDRS10
JDRS11