

THE INFORMATION AND DESIGN HEREIN WAS ORIGINATED BY AND IS THE PROPERTY OF SKYLOCK INDUSTRIES INCORPORATED. SKYLOCK INDUSTRIES INCORPORATED RESERVES ALL PATENT, PROPRIETARY, DESIGN MANUFACTURING, REPRODUCTION, USE AND SALES RIGHTS THERE TO, AND TO ANY ARTICLE DISCLOSED THEREIN EXCEPT TO THE EXTENT RIGHTS ARE EXPRESSLY GRANTED TO OTHERS. THE FOREGOING DOES NOT APPLY TO VENDOR PROPRIETARY PARTS.

REVISIONS				
ZONE	LTR	DESCRIPTION	DATE	APPROVED
	NC	PRODUCTION RELEASE	2-10-94	T. CSIK
	A	DIM. .75 WAS 1.00, PER CUST. REQUEST	2-15-94	T. CSIK

- NOTES: UNLESS OTHERWISE SPECIFIED.
- MAT'L: BUTTON & HOUSING; BRASS, VALVE ASSY; CRES.
 - DECORATIVE FINISH: SATIN CHROME PLATE.

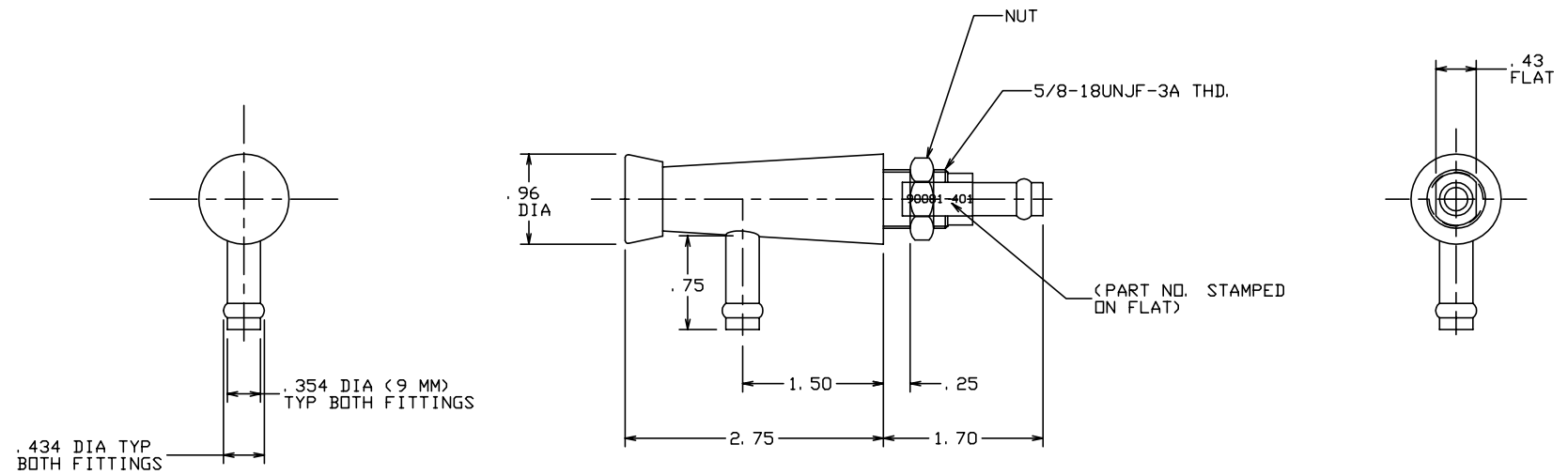

-401 SPIGOT ASSY

-401 SPIGOT ASSY		MATERIAL SIZE SPECIFICATION		ITEM NO.
QTY REQD	PART NO.	DESCRIPTION	MATERIAL	SIZE SPECIFICATION
PARTS LIST				
UNLESS OTHERWISE SPECIFIED		DRAWN BY	T. CSIK	2-10-94
DIMENSIONS ARE IN INCHES		CHECKED	S. CSIK	2-10-94
TOLERANCES ON		ENGINEER	T. CSIK	2-10-94
DECIMALS ANGLES DRILLED HOLES		PROJECT		
.X ± .1 ± 0° 30' AND 10387		APPROVAL	T. SOUZA	2-10-94
.XX ± .03				
.XXX ± .010				
DO NOT SCALE THIS DRAWING		APPROVAL		
MATERIAL - FINISH		USED ON	SIZE	CODE IDENT. NO. DRAWING NO.
NEXT ASSY			C	51941 90081
FINAL ASSY			SCALE	1/1
			WT.	SHEET 1 OF 1

FLUID MEDIA	TYPE	OPERATING PRESSURE	OPERATING TEMP.	FLOW
POTABLE WATER	SELF VENTING & BLEEDING	0-125 PSIG	35°F TO 225°F	100/140 OZ. /MIN. AT 70°F AND 30 P. S. I. INLET PRESSURE

D
C
B
A

D
C
B
A