

THE INFORMATION AND DESIGN HEREIN WAS ORIGINATED BY AND IS THE PROPERTY OF SKYLOCK INDUSTRIES INCORPORATED. SKYLOCK INDUSTRIES INCORPORATED RESERVES ALL PATENT, PROPRIETARY, DESIGN MANUFACTURING, REPRODUCTION, USE AND SALES RIGHTS THERETO, AND TO ANY ARTICLE DISCLOSED THEREIN EXCEPT TO THE EXTENT RIGHTS ARE EXPRESSLY GRANTED TO OTHERS. THE FOREGOING DOES NOT APPLY TO VENDOR PROPRIETARY PARTS.

REVISIONS				
ZONE	LTR.	DESCRIPTION	DATE	APPROVED
	B	REVISE AND REDRAW	1.3.92	SC
	C	ADDED -407 AND -409	1.4.92	SC

NOTES: UNLESS OTHERWISE SPECIFIED

- REMOVE ALL BURRS AND SHARP EDGES
- MAT'L: ALUM; 2024-T3 ALUM ALLOY; ALL OTHER COMPONENTS; CRES
- FINISH: ALUM; SATIN BRUSH AND CLEAR ANODIZE; CRES; PASSIVATE
- FINISH: ALUM; BRIGHT POLISH AND CANDY APPLE RED ANODIZE; CRES; PASSIVATE
- ROTATION: 180 DEGREES, DETENTED EVERY 45 DEGREES
- ROTATION: 90 DEGREES LEFT HAND, DETENTED EVERY 45 DEGREES
- ROTATION: 90 DEGREES RIGHT HAND, DETENTED EVERY 45 DEGREES
- STATIC LOAD: 1000 LBS
- ALL RETAINERS HAVE THREADS COATED WITH VICIOUS COATING VIBRATITE
- ADJUST TORQUE ON SHAFT SUCH THAT MAX. FORCE TO MOVE HANDLE FROM ONE DETENT POSITION TO ANOTHER SHALL NOT BE LESS THAN 3 LBS NOR MORE THAN 4.5 LBS APPLIED TO THE SIDE OF THE HANDLE 4.32 INCHES FROM THE CENTER OF ROTATION

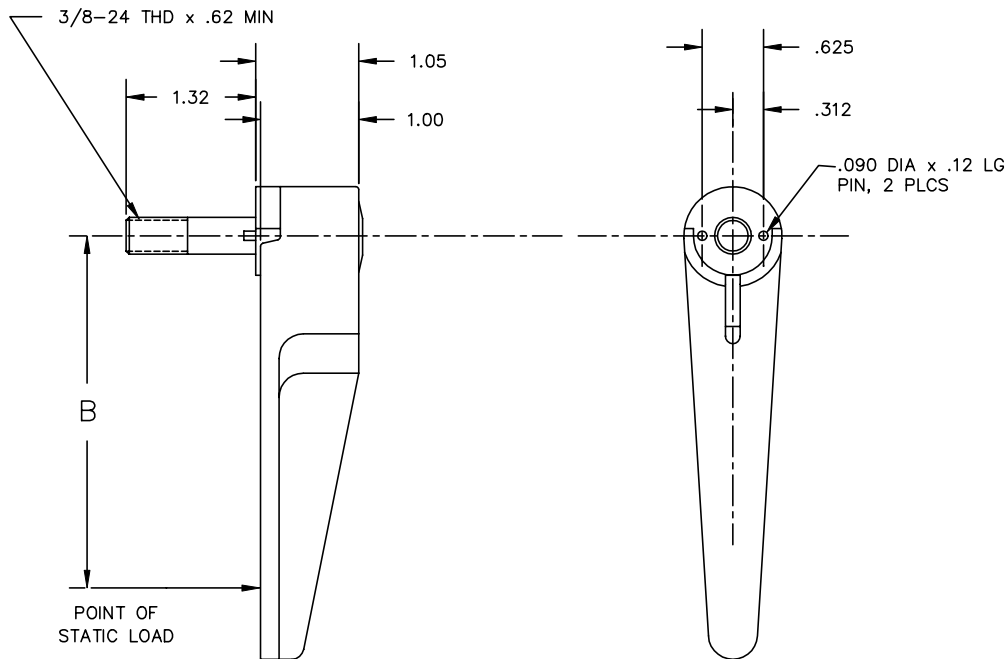
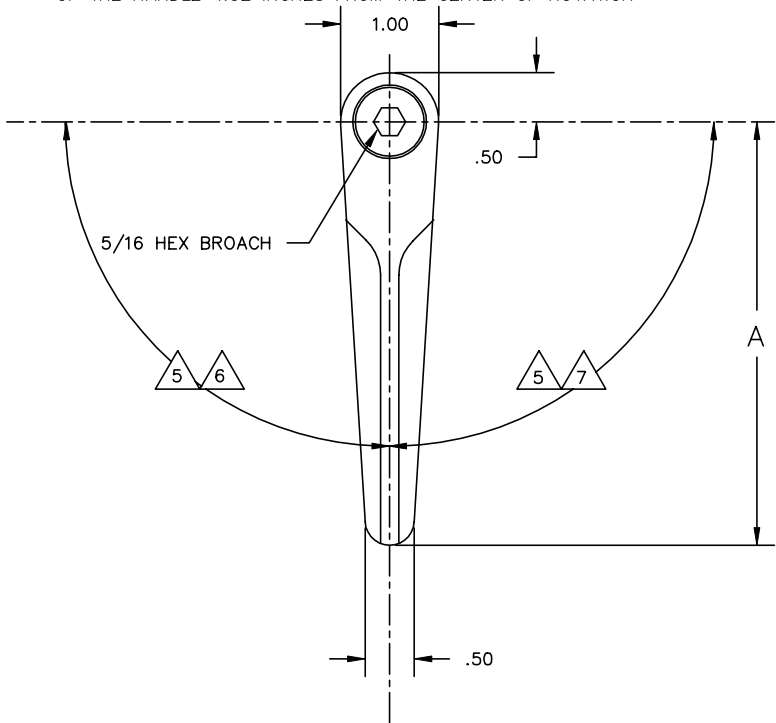

3.00	3.38		-409	RETAINER		
3.00	3.38		-407	RETAINER		
4.32	5.00		-405	RETAINER		
4.32	5.00		-403	RETAINER		
4.32	5.00		-401	RETAINER		
B	A	QTY. REQ'D	PART / IDENT NO.	DESCRIPTION	MATERIAL / SPECIFICATION	ITEM NO.

UNLESS OTHERWISE SPECIFIED: DIMENSIONS ARE IN INCHES		CONTRACT NO.		SKYLOCK INDUSTRIES INCORPORATED MONROVIA, CALIFORNIA, USA
TOLERANCES DECIMALS .XX ±.03 .XXX ±.010		CUSTOMER		
ANGULAR ± 0 30'		DRAWN BY S. CSIK		1/4 TURN RETAINER
DO NOT SCALE DRAWING		DATE 1.3.92		
NEXT ASSY	FINAL ASSY	DESIGN S. CSIK		SCALE NONE
		DATE 1.3.92		
USED ON	DESIGN ACTIVITY		SIZE C	FSCM NO. 51941
FINISH	ACT WT	CALC WT	DRAWING NO. 20643	
			RELEASE DATE 1.3.92	REV. B
			SHEET 1 OF 1	

DRAWING NO. SHEET OF