

THE INFORMATION AND DESIGN HEREIN WAS ORIGINATED BY AND IS THE PROPERTY OF SKYLOCK INDUSTRIES INCORPORATED. SKYLOCK INDUSTRIES INCORPORATED RESERVES ALL PATENT, PROPRIETARY, DESIGN MANUFACTURING, REPRODUCTION, USE AND SALES RIGHTS THERETO, AND TO ANY ARTICLE DISCLOSED THEREIN EXCEPT TO THE EXTENT RIGHTS ARE EXPRESSLY GRANTED TO OTHERS. THE FOREGOING DOES NOT APPLY TO VENDOR PROPRIETARY PARTS.

REVISIONS				
ZONE	LTR	DESCRIPTION	DATE	APPROVED
	B	SEE ECN B	3/12/99	T. CSIK

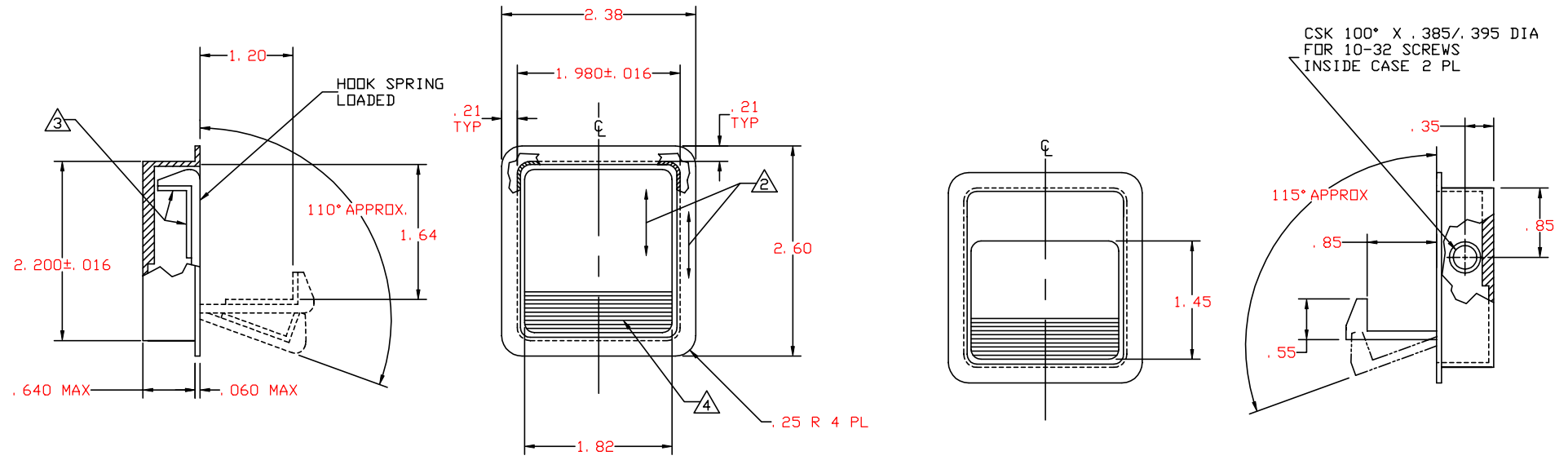

-1 DOOR LATCH

-3 DOOR LATCH
(S/A -1 EXCEPT AS NOTED)

5. PER FAR 45.15. PARTS WILL BE IDENTIFIED WITH:

1. FAA-PMA.
2. SKYLOCK IND. INC.
3. PART NO.
4. AIRCRAFT ELIGIBILITY.

- ④ OPERATION: TO EXTEND HOOK PUSH ON SERRATED AREA.
- ③ CORK P/N: 94545K21, P/N OF MCMASTER-CARR SUPPLY CO., SANTA FE SPRINGS, CA.
- ② DECORATIVE FINISH: SATIN BRUSH DIRECTION NOTED & CLEAR-ANODIZE PER MIL-A-8625, TYPE II, CLASS 1.

1. MAT'L: HOUSING AND HOOK; 2024-T4/T351 PER ASTM B-221, OR EQUIV. SPRING; 303 CRES, COND. A, PER AMS-5640N OR EQUIV. PAD; NATURAL CORK/RUBBER.

REMOVE ALL BURRS AND SHARP CORNERS.
NOTES: UNLESS OTHERWISE SPECIFIED

PART NO.		DESCRIPTION	MATERIAL	SIZE	APPLICATION	MAKE FROM
		-3 DOOR LATCH				120111-3
		-1 DOOR LATCH				120111-1

PARTS LIST						
UNLESS OTHERWISE SPECIFIED	DRAWN BY	S. CSIK	12/12/93	SKYLOCK INDUSTRIES INCORPORATED MONROVIA CALIFORNIA U. S. A.	DOOR LATCH	
DIMENSIONS ARE IN INCHES	CHECKED	L. GARCIA	3/12/99			
TOLERANCES ON	ENGINEER	T. CSIK	3/12/99			
DECIMALS ANGLES DRILLED HOLES	MFG	P. MATSUOKA	3/15/99			
.X ± .1 ± 0° 30' AND 10387	QC	J. VIVIRITO	3/30/99			
.XX ± .03						
.XXX ± .010						
DO NOT SCALE THIS DRAWING						
MATERIAL - FINISH	USED ON	SIZE	CODE IDENT. NO.	DRAWING NO.	REV.	
		C	51941	20111	B	
NEXT ASSY		SCALE	1: 1	VT.	SHEET	1 OF 1
MANUFACTURE IN ACCORDANCE WITH SKYLOCK QUALITY CONTROL MANUAL QC.001						