

THE INFORMATION AND DESIGN HEREIN WAS ORIGINATED BY AND IS THE PROPERTY OF SKYLOCK INDUSTRIES INCORPORATED. SKYLOCK INDUSTRIES INCORPORATED RESERVES ALL PATENT, PROPRIETARY, DESIGN MANUFACTURING, REPRODUCTION, USE AND SALES RIGHTS THERE TO, AND TO ANY ARTICLE DISCLOSED THEREIN EXCEPT TO THE EXTENT RIGHTS ARE EXPRESSLY GRANTED TO OTHERS. THE FOREGOING DOES NOT APPLY TO VENDOR PROPRIETARY PARTS.

REVISIONS				
ZONE	LTR	DESCRIPTION	DATE	APPROVED
	E	SEE ECN E		

- .91 BOLT PROJECTION (FOR -1 ONLY)
- .81 BOLT PROJECTION (FOR -3 ONLY)
- 1.12 BOLT PROJECTION (FOR -5 ONLY)
- .91 BOLT PROJECTION (FOR -7 ONLY)
- 1.00 BOLT PROJECTION (FOR -11 ONLY)
- 1.06 BOLT PROJECTION (FOR -13 ONLY)

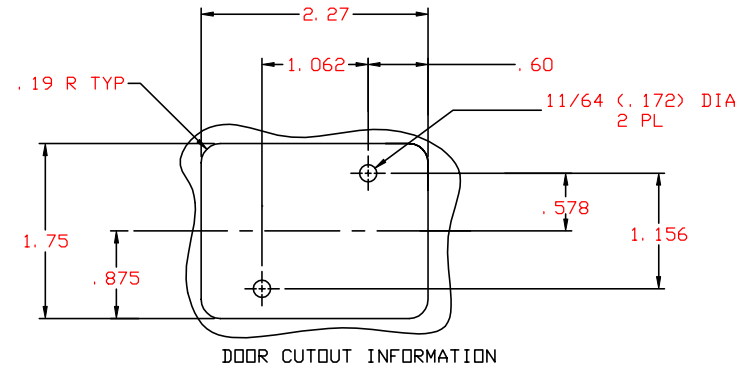
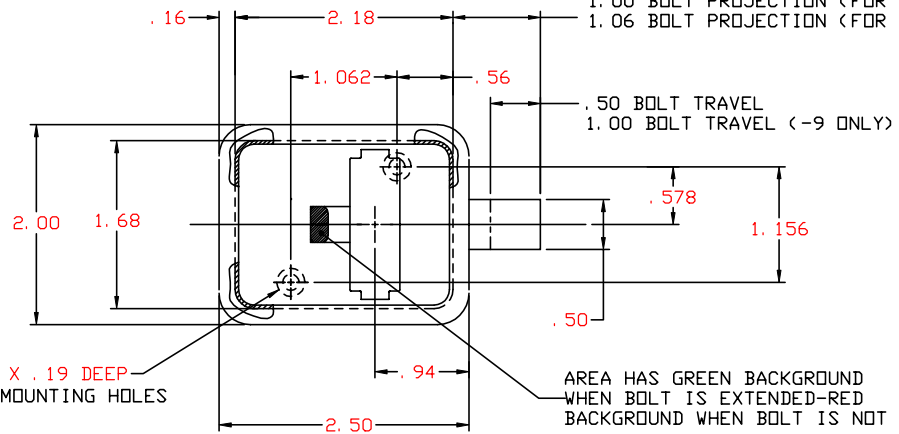

NO. 8-32 X .19 DEEP
MIN. MOUNTING HOLES
2 PL

AREA HAS GREEN BACKGROUND
WHEN BOLT IS EXTENDED-RED
BACKGROUND WHEN BOLT IS NOT FULLY LATCHED.

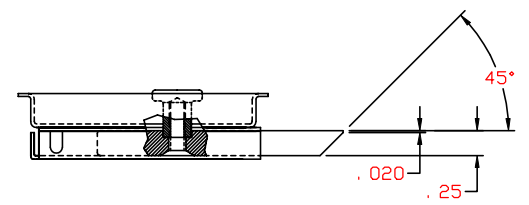
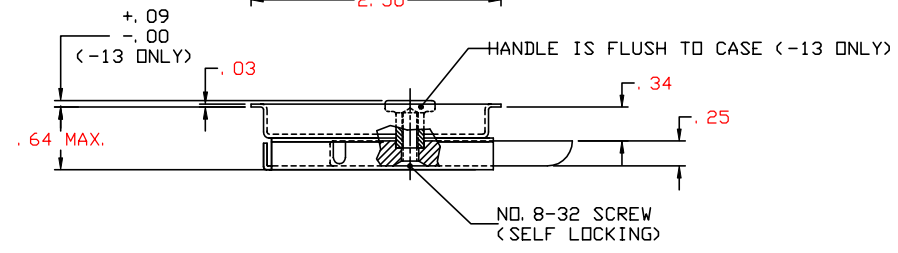

-1, -5, -9, -11, -13 LATCH (SHOWN)

-3 & -7 LATCH
(SAME AS -1 EXCEPT AS SHOWN)

7. APPLICABLE TO FAA-PMA REPLACEMENT OR MODIFICATION PARTS ONLY. PER FAR 45.15, PARTS WILL BE IDENTIFIED WITH:
1. FAA-PMA.
 2. SKYLOCK IND. INC.
 3. PART NO.
 4. AIRCRAFT INSTALLATION ELIGIBILITY.

- ⚠ BOLT IS SPRING LOADED AND ALWAYS FREE TO LATCH.
- ⚠ BOLT IS DETENTED IN EXTENDED AND RETRACTED POSITION.

4. THE FOLLOWING STATIC LOAD IS FOR REFERENCE USE ONLY. IT IS PROVIDED FOR CUSTOMER ENGINEERING TO DETERMINE THE GENERAL SUITABILITY OF THE PRODUCT FOR ITS INTENDED USE. ALTHOUGH SKYLOCK IS PROVIDING THE REFERENCE STATIC LOAD, THE CUSTOMER IS ULTIMATELY RESPONSIBLE FOR CERTIFICATION OF THE PRODUCT FOR ITS SPECIFIC APPLICATION. REFERENCE STATIC LOAD: 600 LBS. MAX.

3. DECORATIVE FINISH REF.: SATIN BUFF LENGTHWISE TO PART SURFACE.

⚠ FINISH REF.: HANDLE; CLEAR ANODIZE PER MIL-A-8625, TYPE II, CLASS 1, OR EQUIV. CRES PARTS; PASSIVATE PER AMS-QQ-P-35, TYPE II, OR EQUIV.

⚠ MATL REF.: HANDLE; 6061-T6/T651, PER ASTM B-221, OR EQUIV. ALL OTHER PARTS; 303 CRES, COND. A, PER AMS-5640N OR EQUIV.

REMOVE ALL BURRS AND SHARP CORNERS.

NOTES: UNLESS OTHERWISE SPECIFIED

QTY REQD	PART NO.	DESCRIPTION	MATERIAL	SIZE	APPLICATION	MAKE FROM
	-13	LATCH-DETENTED	⚠	⚠	⚠	120066-13
	-11	LATCH-DETENTED	⚠	⚠	⚠	120066-11
	-9	LATCH-DETENTED	⚠	⚠	⚠	120066-9
	-7	LATCH-SPRING LOADED	⚠	⚠	⚠	120066-7
	-5	LATCH-DETENTED	⚠	⚠	⚠	120066-5
	-3	LATCH-SPRING LOADED	⚠	⚠	⚠	120066-3
	-1	LATCH-DETENTED	⚠	⚠	⚠	120066-1

PARTS LIST		DRAWN BY M FOSTER		SKYLOCK INDUSTRIES INCORPORATED MONROVIA CALIFORNIA U. S. A.	
UNLESS OTHERWISE SPECIFIED		CHECKED		20066 LATCH	
DIMENSIONS ARE IN INCHES		ENGINEER			
TOLERANCES ON		MFG			
DECIMALS ANGLES DRILLED HOLES		QC			
.X ± .1 ± 0° 30' AND 10387				SIZE C	
.XX ± .03				CODE IDENT. NO. 51941	
.XXX ± .010				DRAWING NO. 20066	
DO NOT SCALE THIS DRAWING				REV. E	
MATERIAL - FINISH		USED ON		SCALE 1:1	
NEXT ASSY				WT.	
MANUFACTURE IN ACCORDANCE WITH SKYLOCK IND. INC., QUALITY CONTROL MANUAL QC.001				SHEET 1 OF 1	