

THE INFORMATION AND DESIGN HEREIN WAS ORIGINATED BY AND IS THE PROPERTY OF SKYLOCK INDUSTRIES INCORPORATED. SKYLOCK INDUSTRIES INCORPORATED RESERVES ALL PATENT, PROPRIETARY, DESIGN MANUFACTURING, REPRODUCTION, USE AND SALES RIGHTS THERE TO, AND TO ANY ARTICLE DISCLOSED THEREIN EXCEPT TO THE EXTENT RIGHTS ARE EXPRESSLY GRANTED TO OTHERS. THE FOREGOING DOES NOT APPLY TO VENDOR PROPRIETARY PARTS.

DASH NO.	SCREW TAB.
-1, -3, -9 THRU -17	NAS603-15
-5, -19	NAS603-22
-7	NAS603-20

REVISIONS				
ZONE	LTR	DESCRIPTION	DATE	APPROVED
	D	REDRAW	5/11/88	TS
	E	ADD -15 & -17	4/18/89	TS
	F	ADD -19	1/12/90	SC
	G	SEE ECN G	1/27/99	T. CSIK
	H	SEE ECN H		
	J	SEE ECN J	9/14/99	E. WELSH

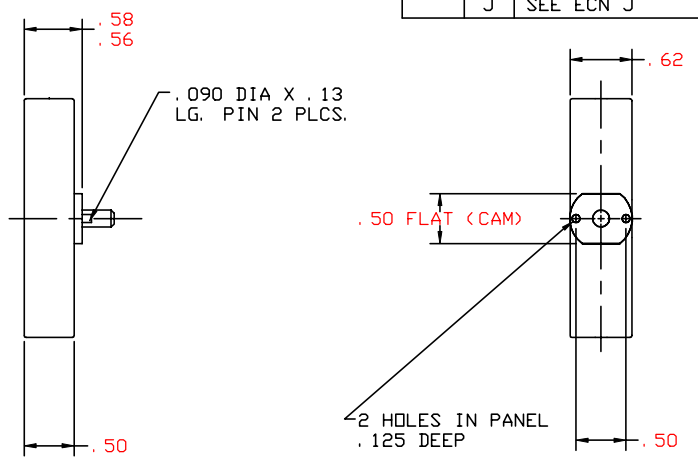
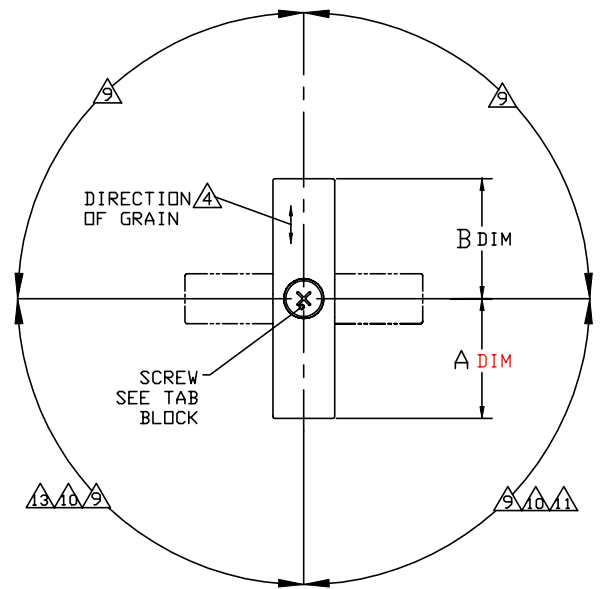

-1 THRU -19 RETAINER

14. APPLICABLE TO FAA-PMA REPLACEMENT OR MODIFICATION PARTS ONLY. PER FAR 45.15, PARTS WILL BE IDENTIFIED WITH:
1. FAA-PMA.
  2. SKYLOCK IND. INC.
  3. PART NO.
  4. AIRCRAFT INSTALLATION ELIGIBILITY.

- △3 ROTATION: 90° LEFT HAND.
  - △2 BRIGHT POLISH AND ANODIZE PER MIL-A-8625, TYPE II TYPE II, CLASS 2, DYED GREEN, OR EQUIV.
  - △1 ROTATION: 90° RIGHT HAND.
  - △10 ROTATION: 180°.
  - △9 ROTATION: 360°.
  - 8. DETENTED EVERY 90° OF ROTATION.
  - 7. REMOVED.
  - 6. THE FOLLOWING STATIC LOAD IS FOR REFERENCE USE ONLY. IT IS PROVIDED FOR CUSTOMER ENGINEERING TO DETERMINE THE GENERAL SUITABILITY OF THE PRODUCT FOR ITS INTENDED USE. ALTHOUGH SKYLOCK IS PROVIDING THE REFERENCE STATIC LOAD, THE CUSTOMER IS ULTIMATELY RESPONSIBLE FOR CERTIFICATION OF THE PRODUCT FOR ITS SPECIFIC APPLICATION. REFERENCE STATIC LOAD: 1000 LBS. MAX. /SIDE. 2800 LBS. /MAX. BOTH SIDES.
  - △5 DECORATIVE FINISH REF.: BRIGHT POLISH AND ANODIZE PER MIL-A-8625, TYPE II CLASS 2, DYED CANDY APPLE RED OR EQUIV.
  - △4 DECORATIVE FINISH REF.: SATIN BUFF AND CLEAR ANODIZE PER MIL-A-8625, TYPE II, CLASS 1, OR EQUIV.
  - 3. FINISH REF.: ALUM PARTS; CLEAR ANODIZE PER MIL-A-8625, TYPE II, CLASS 1, OR EQUIV. CRES PARTS; PASSIVATE PER AMS-QQ-P-35, TYPE II, OR EQUIV. SCREW; CAD PLATE PER QQ-P-416 TYPE II, CLASS 2, OR EQUIV.
  - 2. MAT'L REF.: TURN; 6061-T6/T651 PER ASTM B-221, OR EQUIV. ALL OTHER PARTS; 303 CRES, COND. A, PER AMS-5640N, OR EQUIV.
  - 1. REMOVE ALL BURRS AND SHARP CORNERS.
- NOTES: UNLESS OTHERWISE SPECIFIED.

QTY REQ	PART NO.	DESCRIPTION	MATERIAL	SIZE	APPLICATION	MAKE FROM
1.19	1.19	-19 RETAINER	△4 △13			120196-19
3.00	1.19	-17 RETAINER	△4 △13			120196-17
3.00	1.19	-15 RETAINER	△4 △13			120196-15
1.625	1.625	-13 RETAINER	△4 △10			120196-13
1.19	1.19	-11 RETAINER	△5 △10			120196-11
1.19	1.19	-9 RETAINER	△4 △10			120196-9
1.19	1.19	-7 RETAINER	△4 △9			120196-7
1.19	1.19	-5 RETAINER	△5 △9			120196-5
1.19	1.19	-3 RETAINER	△5 △9			120196-3
1.19	1.19	-1 RETAINER	△4 △9			120196-1

**PARTS LIST**

UNLESS OTHERWISE SPECIFIED	DRAWN BY	SINGELAKIS, T	5/11/88
DIMENSIONS ARE IN INCHES	CHECKED	DEAN VO	1/22/99
TOLERANCES ON	ENGINEER	T. CSIK	1/27/99
DECIMALS ANGLES DRILLED HOLES	MFG	P. MATSUOKA	1/28/99
.X ± .1 ± 0° 30' AND 10387	QC	J. VIVIRITO	2/2/99
.XXX ± .010			

DO NOT SCALE THIS DRAWING

MATERIAL - FINISH USED ON

NEXT ASSY

MANUFACTURE IN ACCORDANCE WITH SKYLOCK IND. INC., QUALITY CONTROL MANUAL QC 001

SCALE 1: 1

VT.

SHEET 1 OF 1

SKYLOCK INDUSTRIES INCORPORATED  
MONROVIA CALIFORNIA U. S. A.

20196 RETAINER

SIZE C CODE IDENT. NO. 51941 DRAWING NO. 20196 REV. J