

THE INFORMATION AND DESIGN HEREIN WAS ORIGINATED BY AND IS THE PROPERTY OF SKYLOCK INDUSTRIES INCORPORATED. SKYLOCK INDUSTRIES INCORPORATED RESERVES ALL PATENT, PROPRIETARY, DESIGN MANUFACTURING, REPRODUCTION, USE AND SALES RIGHTS THERE TO, AND TO ANY ARTICLE DISCLOSED THEREIN EXCEPT TO THE EXTENT RIGHTS ARE EXPRESSLY GRANTED TO OTHERS. THE FOREGOING DOES NOT APPLY TO VENDOR PROPRIETARY PARTS.

REVISIONS				
ZONE	LTR	DESCRIPTION	DATE	APPROVED
	G	SEE ECN G	12/23/98	T. CSIK

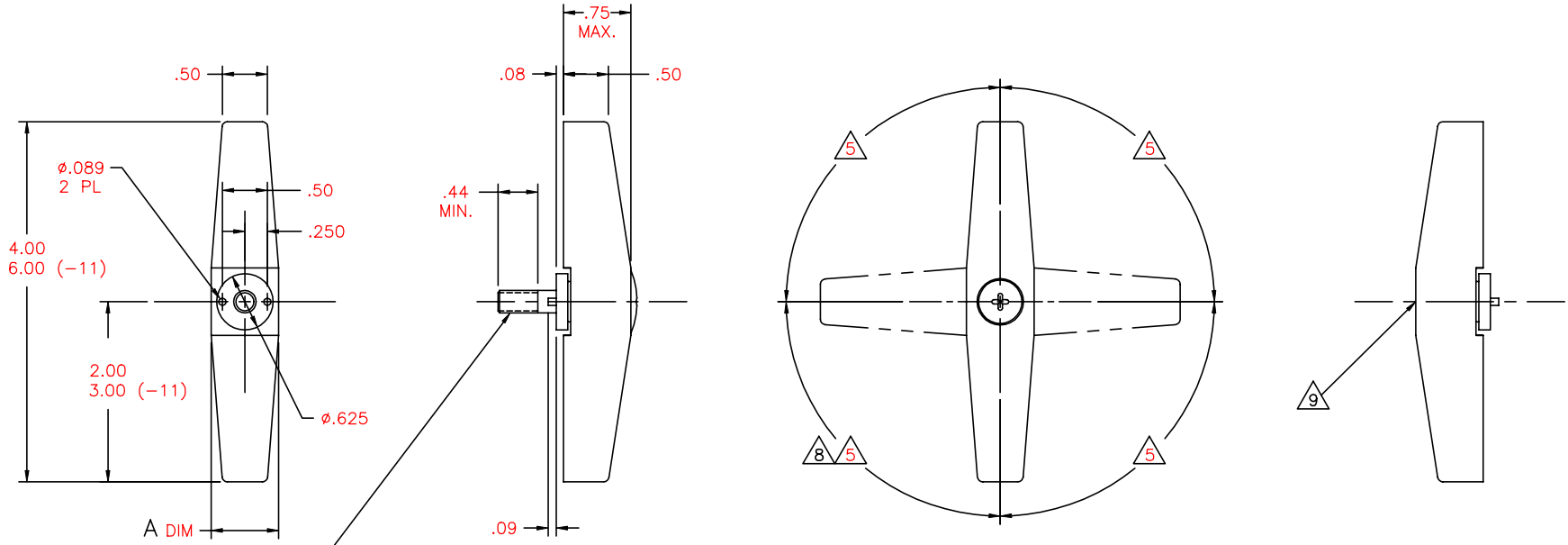

-1, -3, -9, -11 RETAINER      -5 & -7 ONLY

10. PER FAR 45.15, PARTS WILL BE IDENTIFIED WITH:

1. FAA-PMA
2. SKYLOCK IND. INC.
3. PART NO.
4. AIRCRAFT ELIGIBILITY

⑨ SHIP WITHOUT SCREW.

⑧ 90° ROTATION L.H. DETENTED.

⑦ FINISH: TURN; SATIN BRUSH LENGTHWISE TO PART SURFACE AND CLEAR ANODIZE PER MIL-8625, TYPE II, CLASS I. FINISH: CAM-PASSIVATE AMS-QQ-P-35, TYPE II OR VI.

⑥ REMOVED

⑤ 360° ROTATION, DETENTED EACH 90°.

④ REMOVED

③ REMOVED

② FINISH: CAM-PASSIVATE AMS-QQ-P-35,TYPE II OR VI. FINISH: BRIGHT POLISH AND ANODIZE PER MIL-A-8625, TYPE II, CLASS 2, DYED CANDY APPLE RED.

1. MATERIAL: TURN, ALUMINUM ALLOY; 2024-T3/T351 PER ASTM B-209 OR EQUIV. CAM-303/304 CRES, CONDITION A, PER AMS-5640N OR EQUIV.

NOTES: UNLESS OTHERWISE SPECIFIED.

SIZE	PART NO.	DESCRIPTION	MATERIAL	SIZE	APPLICATION	ITEM NO.
.90	-11	RETAINER	②			
.75	-9	RETAINER	⑦ ⑤			
.75	-7	RETAINER	② ⑧ ⑨			
.75	-5	RETAINER	⑦ ⑧ ⑨			
.90	-3	RETAINER	②			
.75	-1	RETAINER	②			

PARTS LIST			
UNLESS OTHERWISE SPECIFIED	DRAWN BY	JEE	12/14/79
DIMENSIONS ARE IN INCHES	CHECKED	D. VO	12/18/98
TOLERANCES ON	ENGINEER	T. CSIK	12/23/98
DECIMALS ANGLES DRILLED HOLES	MFG	P. MATSUOKA	12/29/98
.X .1 0° 30' AND 10387	Q.C.	J. VIVIRITO	12/29/98
.XX .03			
.XXX .010			
DO NOT SCALE THIS DRAWING	USED ON		
MATERIAL - FINISH	SIZE	CODE IDENT. NO.	DRAWING NO.
	C		20333
MANUFACTURE IN ACCORDANCE WITH SKYLOCK IND. INC. QUALITY CONTROL MANUAL QC.001	SCALE	1/1	WT. SHEET 1 OF 1



RETAINER

REV.	G
------	---